

ANN ARBOR CIVIC THEATRE
Presents

Harvey



by Mary Chase

October 21-24, 1981
Michigan Theatre, 8:00 pm

schlanderer

JEWELRY AND FINE WATCHES

1113 SOUTH UNIVERSITY, ANN ARBOR

662-3773

after the theatre . . .

THE WHIFFLETREE

208 W. HURON

HOURS: Monday - Saturday, 11:30 a.m. to 2:00 a.m.
Kitchen open 'til Midnight Monday - Thurs.,
'til 1:00 a.m. Fri. & Sat.
Sunday 4:00 p.m. to 1:00 a.m.
Kitchen open 'til midnight.

(313) 761-3615

Keep your spirits up!



ANN ARBOR PARTY CENTER, INC.
1612 Jackson Ave. • Ann Arbor, MI 48103



People Plus Performance

The Citizens Bank of Saline

Member F.D.I.C.

Main Office
100 West Michigan Avenue
Saline, Michigan 48176
(313) 429-5461

Lodi Township Office
4997 Saline-Ann Arbor Road
994-1340

Augusta Township Office
5300 East Willis Road
483-5821

The U-M Professional Theatre Program
Michigan Ensemble Theatre

WINGS

BY ARTHUR KOPIIT

OCT 29 • NOV 1, NOV 5 • 8 8 PM

Sunday matinees at 2 PM

Lydia Mendelssohn Theatre
Tickets at PTP in the Michigan League
CALL 764-0450

ANN ARBOR CIVIC THEATRE

Presents
Harvey



By Mary Chase

Produced by Special Arrangement with
the Dramatists Play Service, Inc.

Synopsis of the Scenes

The action of the play takes place in the Far West in the library of the old Dowd family mansion and the reception room of Chumley's Rest.

Act I, Scene 1	The Dowd Library Midafternoon of a Spring Day
Act I, Scene 2	Chumley's Rest, an Hour Later
Act II, Scene 1	The Dowd Library, an Hour Later
Act II, Scene 2	Chumley's Rest, Four Hours Later
Act III	Chumley's Rest, a Few Minutes Later



*Best Wishes
For Another
Successful
Season.*



**ANN ARBOR
TRUST**

THE BANK OF TRUST

Main at Huron/994-5555 • State at Airport Drive/996-8595
Brighton Office/227-5551 • Chelsea Office/475-9154
Member FDIC

**The Travel
Professionals**

Plymouth Mall
Wolverine Tower
South University



CONLIN TRAVEL



Jacobson's

Ann Arbor Civic Theatre, Inc.

Board of Directors

Chris Schwartz, President
Burnette Staebler
Mergie Cohen
Ted Heusel
Carolyn Lewis-Stone
Kathyleen Genik

Kathleen Foss-Harsen
Marty Smith
Earl Miner
Robert Seeman
Louisa Pieper
Sandra Hudson

Patrons

Fred & Sue Beutler
Mark & Mindy Bowles
Mergie Cohen
Raymond & Janet Crabtree
John & Natalie Dale
Bernard & Carol Ehns
Warren & Virginia Eveland
Marie C. Gilson
Leo & Deborah McNamara
Margaret Massialas
The Rev. Canon G. Alexander Miller
Cruse & Ginny Moss
C. & Ruth Samborski
Joan Scheffler
Gerard Scofield
Robert & Marina Seeman
Dwight S. Smith
Neil & Burnette Staebler
Judith Dow Towsley
Allison E. Weeber

Season Staff:

Publicity
Front of House
Box Office
Season Ticket Agent
Membership

Main Street Production Coordinator
Program Editor
SPOTLIGHT Newsletter Editor
Social Chair

Kathleen Harsen
Ted Heusel
Louisa Pieper
Mabel Jones
Revella Woodson
Sandra Hudson
Charles Sutherland
Kathyleen Genik
Aileen Mengel
Mergie Cohen

To contact any of this staff, or for information regarding ticket availability, auditions and performances, and membership, address inquiries to: AACT, Box 1242, Ann Arbor, MI 48106 or contact the Main Street Office at 662-9405 or 662-7282.

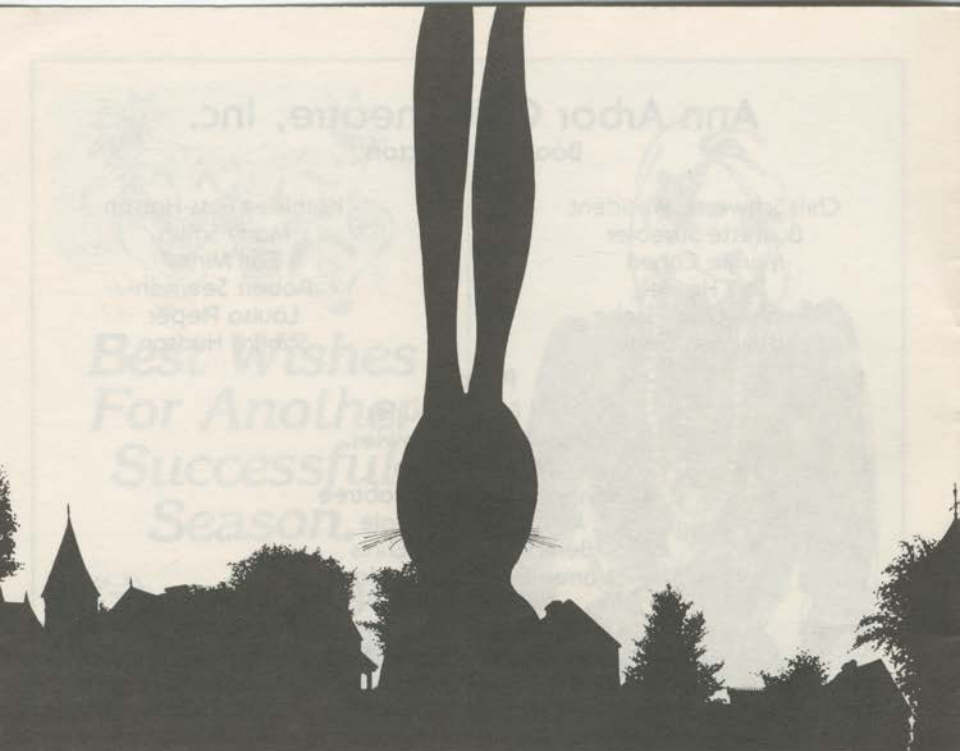

A Note from the Director

The Michigan Theatre is a "first" for the Civic players. Since 1950, the Lydia Mendelssohn Theatre has been our home for major productions. The University's demand for more theatre space prompted our decision to make a contract with the Michigan Theatre Corporation.

The Michigan Theatre has a fine tradition for motion pictures and theatrical productions. The 1930's and 40's featured some great names and great plays.

Realizing that we cannot enjoy the intimacy of the Lydia Mendelssohn, the Civic players have found it a challenge to adapt themselves to a theatre seating three times as many people.

The new experience has been rewarding, not only artistically, but financially. All seating capacity records have been broken for a single week performance.

My thanks to Manager Raymond Messler and the Michigan Theatre Corporation for the opportunity to carry on the fine theatrical traditions of two enterprises—both with over 50 years of service to the Ann Arbor community—the Michigan Theatre and the Ann Arbor Civic Theatre.

Ted Heusel,
Director

The Cast

(In order of appearance)

Housemaid	Kathi Genik
Miss Johnson	Barbara Carron
Myrtle Mae Simmons	Alison Maker
Veta Louise Simmons	Bette Ellis
Elwood P. Dowd	William J. Cross
Mrs. Ethel Chauvenet	Margie Cohen
Mrs. Martha Cummings	Marie Gilson
Ruth Kelly, R.N.	Martha A. Jones
Duane Wilson	Marty Smith
Lyman Sanderson, M.D.	Jim Piper
William R. Chumley, M.D.	John Stephens
Betty Chumley	Aileen Mengel
Judge Omar Gaffney	Leo McNamara
E. J. Lofgren	Stephen Kay

About the Cast

BARBARA CARRON (Miss Johnson) appeared in the Black Sheep Repertory's *Vaudeville* and served as stage manager for the Comic Opera Guild's *Naughty Marietta*. For Civic she has served as the stage manager/assistant director for *My Fair Lady*, producer for *Lady Lambert* and appeared in the Ensemble in *Our Town*. Barbara works for Campus Management and enjoys needlepoint.

MARGIE COHEN (Mrs. Ethel Chauvenet) most recently served as Properties and Set Dresser for *Look Homeward, Angel*. Onstage, she has appeared as Joyce in *East Lynne*, Mrs. Soames in *Our Town*, and Mrs. Paddy in *Curious Savage*. Margie is currently serving on the AACT Board of Directors and has served as properties chair for productions of *A Little Night Music*, *A Flea in Her Ear* and *Waltz of the Toreadors*.

WILLIAM J. CROSS (Elwood P. Dowd) first appeared for AACT as the newsboy in *A Streetcar Named Desire* in 1959, and has since appeared in over forty productions for AACT, U of M, EMU, the Theatre Company of Ann Arbor, Canterbury Loft Players and the Black Sheep Repertory Theatre. Bill's most recent roles include George in *Who's Afraid of Virginia Woolf*, Murray in *A Thousand Clowns*, John Proctor in *The Crucible*, Richard Dudgeon in *The Devil's Disciple*, Milo Tindle in *Sleuth*, as well as the title role in the Theatre Company of Ann Arbor's production of *Dracula*. Bill has twice won AACT's Best Actor Award and holds a Masters in Speech and Theatre Arts.

BETTE ELLIS (Veta Louise Simmons) includes among her theatrical experiences off-Broadway work in New York, summer stock, winter stock, and radio, television and film work in character roles. Since joining AACT, Bette has appeared in the roles of Solange Lafitte in *Follies*, Mrs. Springer in *Spofford*, Mrs. Harcourt in *Anything Goes* and has received Civic's Best Supporting Actress Award four times including the roles of Mrs. Beaurevers in *A Shot in the Dark* and Mrs. Dudgeon in *The Devil's Disciple*. Bette is an English teacher at Tappan and holds her Masters in Drama. While in Athens this summer, she dubbed English for the Greek film company, Elpis Films.

KATHI GENIK (Housemaid) appeared as one of the servants in Civic's *A Little Night Music* and has worked on nearly every production since joining AACT. She appeared in the choruses of *Music Man*, *Oliver*, and *Fiddler on the Roof*, as well as in the roles of Mimsey in *Plaza Suite* and Grandma Tzeitel (all with the Saline Area Players). Kathi is a member of the Board of Directors and is serving as season program editor.

MARIE GILSON (Mrs. Martha Cummings) appeared in Civic productions of *Spofford*, *Follies*, *Our Town*, and most recently, *Look Homeward, Angel*. A retired nurse, Marie has appeared in summer stock and is a member of the St. Andrews Players. She also volunteers time in the AACT Main Street office, works box office, and ushers when not onstage.

MARTHA A. JONES (Ruth Kelly, R.N.) makes her AACT debut in this role. She worked as a technician for the 1980 U of M Summer Repertory and brings considerable experience onstage and backstage from the University of Toledo where she appeared as Anne Pierson in *Words and Music*, Princess Mimosa in *Hangman's Sacrifice*, and Nora in *Riders to the Sea*. She narrated and produced *The Gift of the Magi* for WERC Campus Radio, and served as the Stage Manager for *Memoirs* and *Oedipus Rex*. Martha enjoys "bicycling, skiing, cooking . . . photography, good music, and friends."

STEPHEN KAY (E. J. Lofgren) is a newcomer to AACT. His most recent roles include Biff in *Death of a Salesman* with the Rosedale Community Players; Landau in *Cold Storage*, Mortimer in *Arsenic and Old Lace* with the Farmington Players and Jack Chesney in *Charley's Aunt* as well as Mike in *The Wayne-Westland Civic Theatre's Wait Until Dark* and several appearances with the Flint Community Players. Stephen is a golf course architect with William Newcomb Associates in Ann Arbor.

LEO MCNAMARA (Judge Omar Gaffney) has been active for the past decade in Ann Arbor theatre, both for AACT and the University of Michigan. Last season, he was seen as Emily's father, Mr. Webb, in *Our Town* and as the villain, Sir Francis Levison, in *East Lynne*. At the University he played the Actor in the Residential College production of Brecht's *The Resistible Rise of Arturo VI* and in the Professional Theatre Program's *Romeo and Juliet* he appeared as the Prince. His most recent roles were in summer stock, at Timberlake Playhouse in Mt. Carroll, Illinois, where he played Frank Strang in *Equus* and the lead in *Life With Father*.

ALISON MAKER (Myrtle Mae Simmons) has been a very active member of AACT. Her most recent appearances for Civic include Helen in *Look Homeward, Angel*, Amy Spettigue in the studio production of *Charley's Aunt* as well as Abigail in *The Crucible* and Barbara Hare in *East Lynne*. This summer Alison appeared as Miss Caswell in the Black Sheep Repertory's *The Mousetrap*. Her roles with the Pioneer Theatre Guild include Ilona in *The Guardsman* and Barbara Allen in *Dark of the Moon*. Alison is currently a senior at Pioneer High, plays piano, works on her singing and is considering a career in acting.

AILEEN MENGEL (Betty Chumley) received her BA in Speech and Drama from the U of M and is currently teaching at Lawton School. AACT audiences last saw Aileen as Cornelia Carlyle in *East Lynne* and Lily Belle in *The Curious Savage*. She has appeared in the title role of *The Zookeeper*, as Candida in *Candida* and Elvira in *Blithe Spirit*. She has directed for AACT, the Ypsilanti Players and the Livingston Players. Aileen enjoys tennis, walking, reading, travel, and is "still trying to outsmart the raccoons that yearly try to invade the house." Aileen is also the editor for the AACT newsletter, *The Spotlight*.

JIM PIPER (Lyman Sanderson, M.D.) last appeared for Civic as Colonel Hugh Pickering in *My Fair Lady*, as a Forest Ranger in *Little Mary Sunshine* and as Mr. McComas in *You Never Can Tell*. Ann Arbor audiences have seen him in the Musket production of *Music Man* as Mayor Shinn and in the University productions of *The Canterbury Tales* as the Pardoner and *The Boyfriend* as Jean. Jim is a media specialist employed at Pioneer High and holds degrees in English, Theatre, and Library Science from the U of M.

MARTY SMITH (Duane Wilson) recently appeared in the AACT summer stage productions of *Bus Stop* and *The Good Doctor*. His main stage appearances include the roles of Harrison Howell in *Kiss Me Kate*, Mr. Kirby in *You Can't Take It With You*, and Walter Boone in *You Never Can Tell*. Marty also appeared as Dr. Chumley in the 1975 Civic Production of *Harvey*. He is currently serving on the Board of Directors. Marty is a lawyer in Ann Arbor.

JOHN STEPHENS (William R. Chumley, M.D.) was the recipient of the Best Actor Award for the roles of Grandpa in *You Can't Take It With You*, and Spofford in *Spofford*, and received the Best Supporting Actor Award for the role of Chief Sitting Bull in *Annie Get Your Gun*. John's most recent onstage portrayal for Civic was in the role of the Stage Manager in last season's *Our Town*. Area audiences also had a chance to see him in the Black Sheep Repertory's production of *A Thousand Clowns* as Arnold.

WATCH FOR THESE SHOWS!

THE BOYFRIEND by Sandy Wilson

December 16-19, 1981

MAJOR BARBARA by George Bernard Shaw

February 24-27, 1982

CAMELOT by Lerner and Loewe

April 28-May 1, 1982

WITNESS FOR THE PROSECUTION by Agatha Christie

June 23-26, 1982

All Shows Lydia Mendelssohn Theatre

Individual tickets now available for THE BOYFRIEND

Please make checks payable to: Ann Arbor Civic Theatre

Mail Ticket Order to: AACT 1981-82 Season

P. O. Box 1242, Ann Arbor, Michigan 48106

Please mail my tickets for THE BOYFRIEND to:

Name _____

Address _____

City, State, Zip _____

Seating Preference _____Orchestra _____Balcony

No. of Tickets	Day	Ticket Price	Total
	Wednesday*	\$6.00	\$
	Thursday	6.00	
	Friday	7.00	
	Saturday	7.00	

Postage and Handling _____ 0.50

TOTAL PAYMENT ENCLOSED \$ _____

Check or money order enclosed

Charge Master Charge/Master Card Visa/Bank Americard

Account Number

--	--	--	--	--	--	--	--	--	--	--	--	--	--	--	--	--	--	--	--

All digits, please

Expiration Date _____

Signature (Required) _____

The Staff

Director	Ted Heusel
Producer	Carol Deniston
Assistant Director/Stage Manager	Runelda Medrano
Set Design	Don Stewart JoAnn Zeigenfuse
Set Construction	Ted Farah
Costume Design & Construction	Cheryl Berteel
Lighting Design	Mike Limmer
Make-up Design	Sophie Farah
Properties & Set Dressing	Alisande Cutler
Organist	Don Haller

About the Staff

CHERYL BERTEEL (Costume Design & Construction) designed costumes for Civic's productions of *The Devil's Disciple* and *Our Town*, and has built costumes for close to 40 shows, including *Look Homeward, Angel*, *Fiddler on the Roof*, *Okalahoma*, and *Hello Dolly!* Her designs for Grosse Pointe's *Cabaret* were award winning. She served as wardrobe mistress for *A Little Night Music* and worked costume crew for *Kiss Me Kate*, *Guys And Dolls* and *Charley's Aunt*. A former Board member, Cheryl currently serves as costume shop administrator for AACT.

ALISANDE CUTLER (Properties & Set Dressing) Since joining AACT in 1969, she has worked on sets, stage crew, membership, playreading, social committee and served a term on the board of Directors. Now, after a five-year "leave of absence" while she went to law school, Alisande is back at her first and favorite area, props. She considers her work on props for *Man of La Mancha* and *Fiddler on the Roof* to be highlights of her theatrical experience. Alisande also served as assistant director for *Once Upon A Mattress* and was both assistant director and stage manager for *Misalliance*. She is a lawyer in private practice.

CAROL DENISTON (Producer) is serving as producer for the twenty-third time, but she has participated in all aspects of AACT from poster distribution to strike crew to Board President. She works for the U of M Housing at South Quad and looks forward to summers and weekends in South Haven fishing, sunning and reading.

SOPHIE FARAH (Makeup Design) has worked makeup for so many shows she says she'll "probably die with a make-up brush in my hand." She has worked in almost every area of theatre and is a former AACT Board member, *Spotlight* editor, and corresponding secretary. Currently, her favorite hobby is playing with her granddaughter.

TED FARAH (Set Construction Supervisor) joined AACT at the time the Mulholland building was purchased and was involved in its renovation. Ted has built many sets and is a master of special props in the form of Victorian and grand pianos. His smiling face is a familiar one to Wednesday and Saturday audiences, on which days he works the "front of the house" as a ticket taker.

MIKE LIMMER (Lighting Design) is designing his first show for Civic with this production of *Harvey* but is no stranger to AACT light crews. He designed lighting for Excalibur Productions, Little Known Players and the Village Players in Toledo before becoming involved with AACT. Mike is a restaurant manager for Burger King.

RUNELDA MEDRANO (Assistant Director/Stage Manager) has served in this capacity for approximately 11 years and 16 productions, including last season's *Our Town* and *A Flea in Her Ear*. Runelda has served as Board member, Treasurer, Head Usher, *Spotlight* newsletter editor, and recording secretary for the Board and has worked as a member of stage and light crews. Runelda appeared in Civic's *Oklahoma* and *Mame*. She is employed as the business manager for the Management Education Center and enjoys raising and showing St. Bernard Dogs and roller skating.

DON STEWARD (Set Co-design) has designed at least one show for AACT every year for the past 17 years, including *Lady Lambert*, *Curious Savage*, and Carol Duffy's *The Zookeeper*, as well as last season's *East Lynne*. Don is an architectural representative for the Glen Gery Corporation, one of the largest manufacturers of brick in the world.

JOANN ZEIGENFUSE (Set Co-design) is entering her third year of association with AACT. She had worked on costumes and sets for a summer theatre group in Pennsylvania before moving to Ann Arbor. JoAnn has done make-up for many Civic shows, including *My Fair Lady* and *A Flea in Her Ear* as well as for the U of M School of Music. She has helped paint several sets since joining Civic, and also seems to end up co-designing a set with Don Stewart each year. *Harvey* is the third set they've designed together, the most recent being last season's *East Lynne*.

PRODUCTION CREWS

Set Construction

Ted Farah, Supervisor
Jeff Aiken
Glen Davis
Sophie Farah
Betsy Hill
Larry Hill
Michele McGee
Bob Seeman
Marina Seeman
Ken Struble

Costumes

Evelyne Genik
Kathi Genik
Chris Stephens

Make-up

Roberta Rizzardi
Penny Tashnick
JoAnn Zeigenfuse

Hair Designs by

Andrea McCuiston of Downtown Hair & Co.
Mary Ann Archambault

House Carpenter

Arrangement for Tom Ault's services were made through the courtesy of Local 395, Ann Arbor Stage Hands.

Properties and Set Dressing

Angelika Fanslau
Evelyne Genik
Eula Hoffman
Aileen Hyne
B. J. Thompson

Running Crew

Jeff Aiken
Chris Jensen
Joy Scarpuzza
Dwight Smith

Lights

Mike Alexander
Larry Hill
Chris Jensen
Marty Limmer
Dave Mohler

Sound

Roy Schwartz

ACKNOWLEDGEMENTS

Special thanks to Raymond Messler, Manager, Tom Ault and the staff of the Michigan Theatre.

For their generous donation of props, thanks to
Chelsea Flower Shop, Ann Arbor
B. J. Thompson

Victors

Elegant dining for special occasions.

At the Campus Inn • E. Huron at State • Reservations — 769-2282 • Valet Parking

Wilkinson Luggage Shop

327 South Main St.
Ann Arbor, Michigan 48108
Luggage, Leather Goods, Hand Bags, Gifts
DIAL 769-2000 (Area Code 313)



Chelsea Flower Shop

203 E. Liberty St.
Ann Arbor, MI 48108
Phone 313-662-5616

JOHN LEIDY

gifts

601-607 E. Liberty
668-6779



GROSS ELECTRIC INC.

SINCE 1910

2216 S. INDUSTRIAL HIGHWAY
ANN ARBOR, MICHIGAN 48104
(313) 665-8676

Residential, Commercial, Industrial Lighting
Fixtures and Electrical
Supplies

GE Lamps, Nutone Products

STAGEDOOR Restaurant

Your ticket to a Great Performance.

- ★ Now Playing: New, Expanded Menus for Breakfast, Lunch, Dinner and Snacks
- ★ Plus Happy Hour in Two Acts: 4-6 p.m. and 8-10 p.m. Monday- Saturday
- ★ Featuring our famous All-Star Service

Hours:

Lunch Served Monday - Saturday, 11 a.m.-3 p.m.
Dinner Served Monday - Saturday, 5 p.m.-9 p.m.

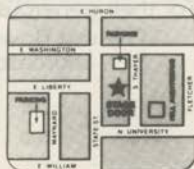

300 S. Thayer 769-3042 — Inside the Bell Tower Hotel

99

Class.

Nothing speaks for a well-managed business like the crisp, alive, quality images printed with precision, care and speed by Gail Graphics.

CLASS TELLS IT ALL.

Gail Graphics, Inc.
203 West Michigan Avenue
Saline, Michigan 48176
(313) 429-5421

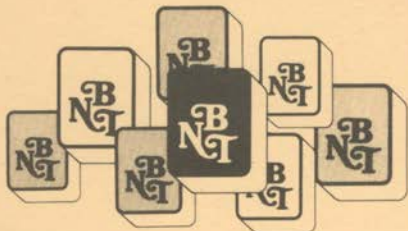

National Bank & Trust

Company of Ann Arbor

Since 1893

Member FDIC

NIELSEN'S

AND NIELSEN'S OF BRIARWOOD
FLOWER SHOP & GREENHOUSES

*Distinctive Floral Designs For All Occasions
Plants and Accessories for Indoor & Outdoor Gardening*

1021 Maiden Lane
Phone 994-6112

For More Exciting
AACT Theatre
Watch for
"Main Street
Productions"

338 South Main St.
662-7282

AN EVENING WITH P.D.Q. BACH FREE TO SEASON SUBSCRIBERS!

Saturday, October 10, 1981 8:30 p.m. Michigan Theatre
Daniel Phillips, violin

Thursday, December 10, 1981 8:00 p.m. Michigan League
Friday, December 11, 1981 8:00 p.m. Michigan League
Christmas Dessert Concerts
Jay de Vries, clarinet

Saturday, January 23, 1982 8:30 p.m. Michigan Theatre
Tibor Szász, piano

Thursday, February 11, 1982 8:00 p.m. Michigan League
Friday, February 12, 1982 8:00 p.m. Michigan League
Valentine Day Dessert Concerts
Principal Violin, Cello, Oboe, and Bassoon Players, soloists

Thursday, April 22, 1982 8:30 p.m. Michigan Theatre
AN EVENING OF THE MUSIC OF P.D.Q. BACH
Professor Peter Schickele, guest conductor



The
Ann
Arbor
Chamber
Orchestra's
1981-82
Subscription
Season

To order Season Tickets
request a brochure or for more information, call 996-0066

Ann Arbor Civic Theatre, Inc.
is a Member of

